

JKA

Ramsgate Place Plan

Public
Engagement



Introduction



Development in Ramsgate

Levelling Up Fund

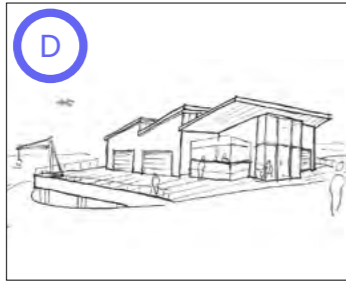
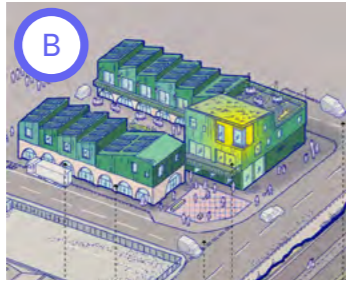

High Street Heritage Action Zone

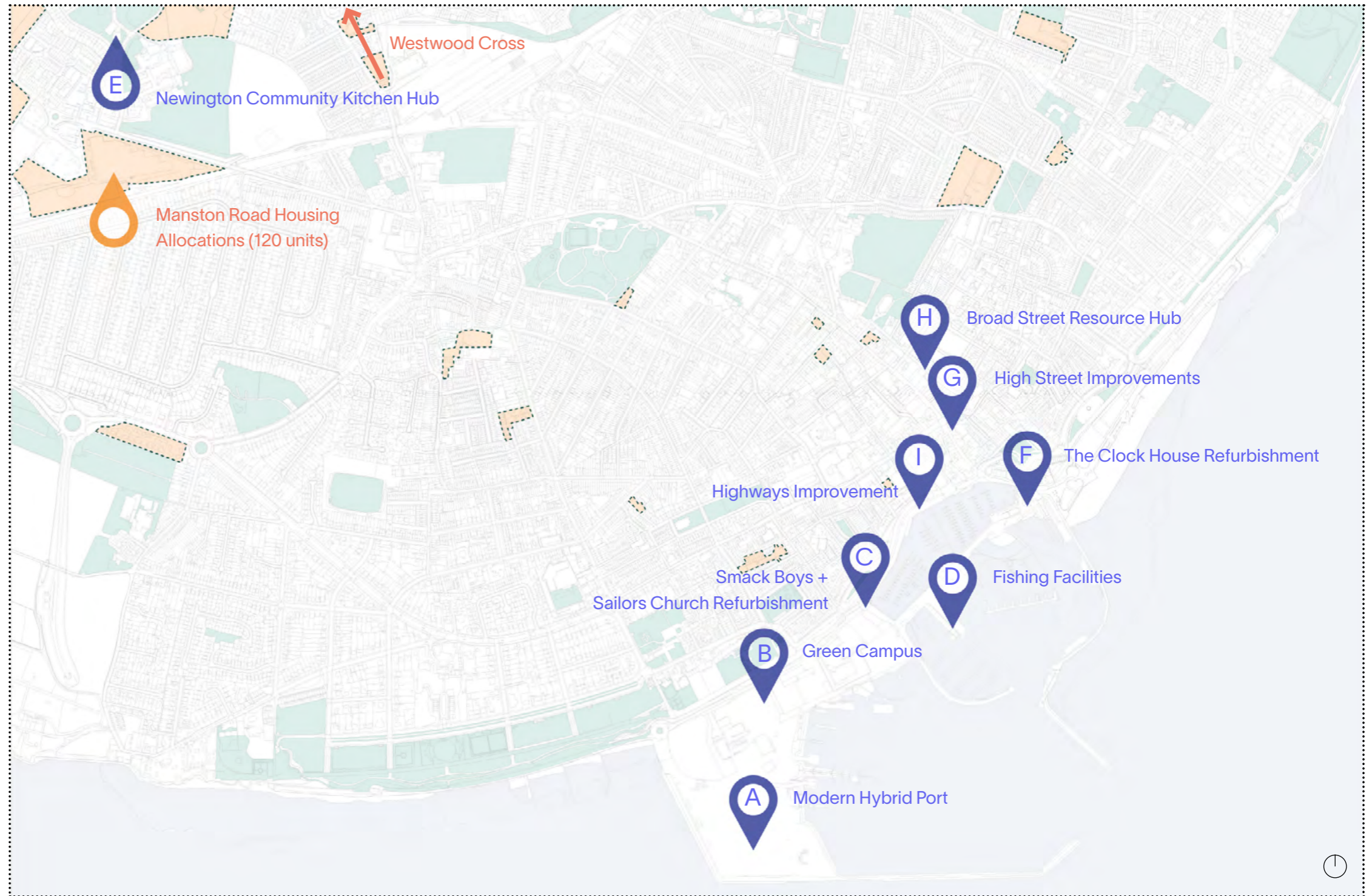
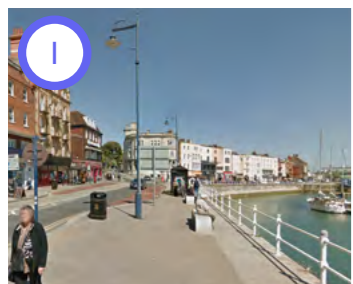

Existing Planning Policy

The Thanet Local Plan was adopted on 9 July 2020, and seeks to guide decisions on the town's development until 2031.

-  Retention of Employment Sites
-  Local Centres
-  Major Holiday Beaches
-  Housing Sites
-  Conservation Area
-  Groundwater Protection
-  Protection of Open Space
-  Special Area of Conservation
-  Site of Special Scientific Interest

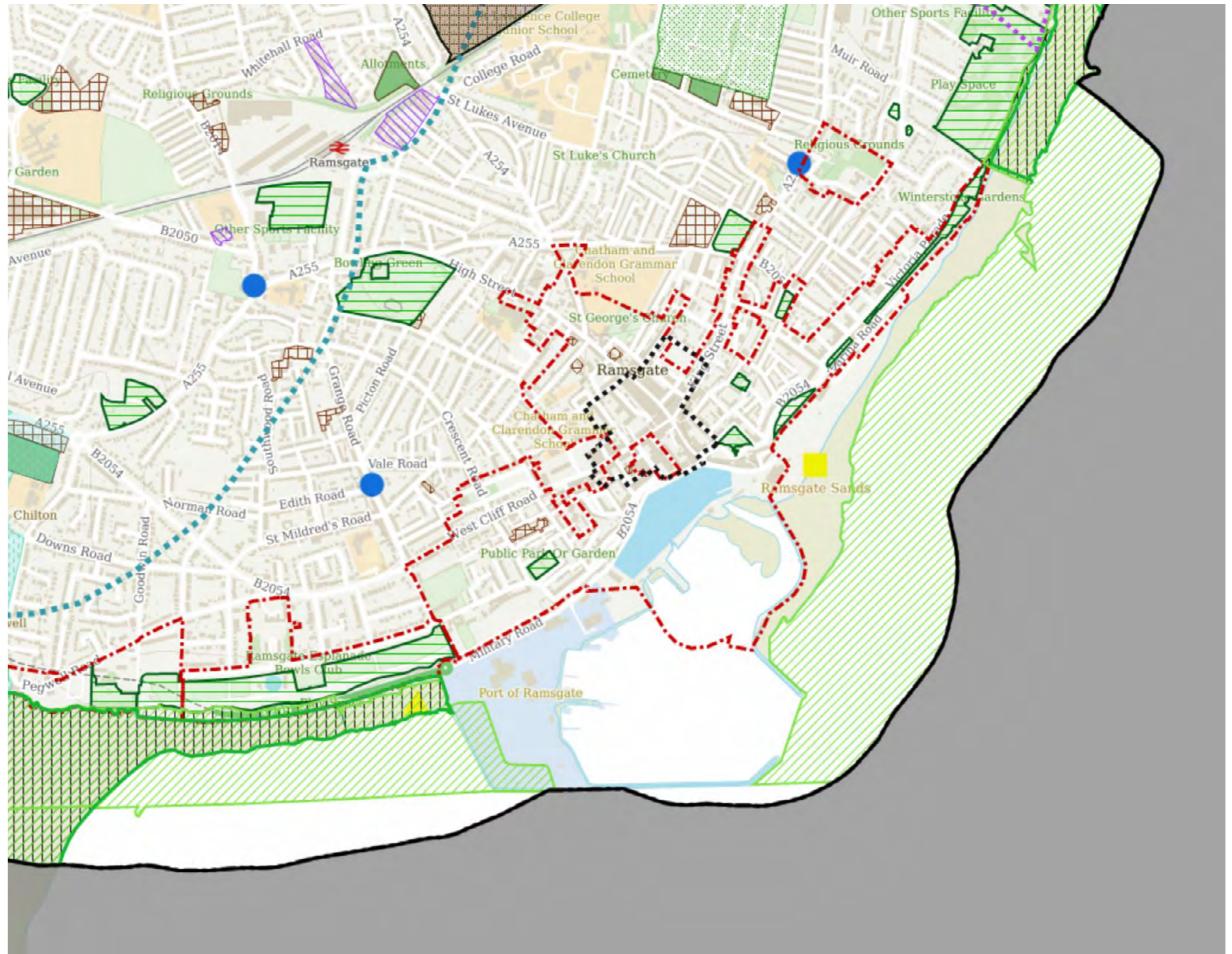

Existing Planning Policy

- 1** Character Area 1: The Royal Harbour
- 2** Character Area 2: Historic Commercial Core
- 3** Character Area 3: East Cliff Seafront
- 4** Character Area 4: Spencer Square and Addington Street
- 5** Character Area 5: Mount Albion Estate
- 6** Character Area 6: Liverpool Lawn
- 7** Character Area 7: Grange Road
- 8** Character Area 8: West Cliff Road
- 9** Character Area 9: Vale Square
- 10** Character Area 10: Effingham Street and environs
- 11** Character Area 11: Upper King Street
- 12** Character Area 12: Upper High Street and Chatham Street
- 13** Character Area 13: Hardres Street and Broad Street
-  Ramsgate Conservation Area

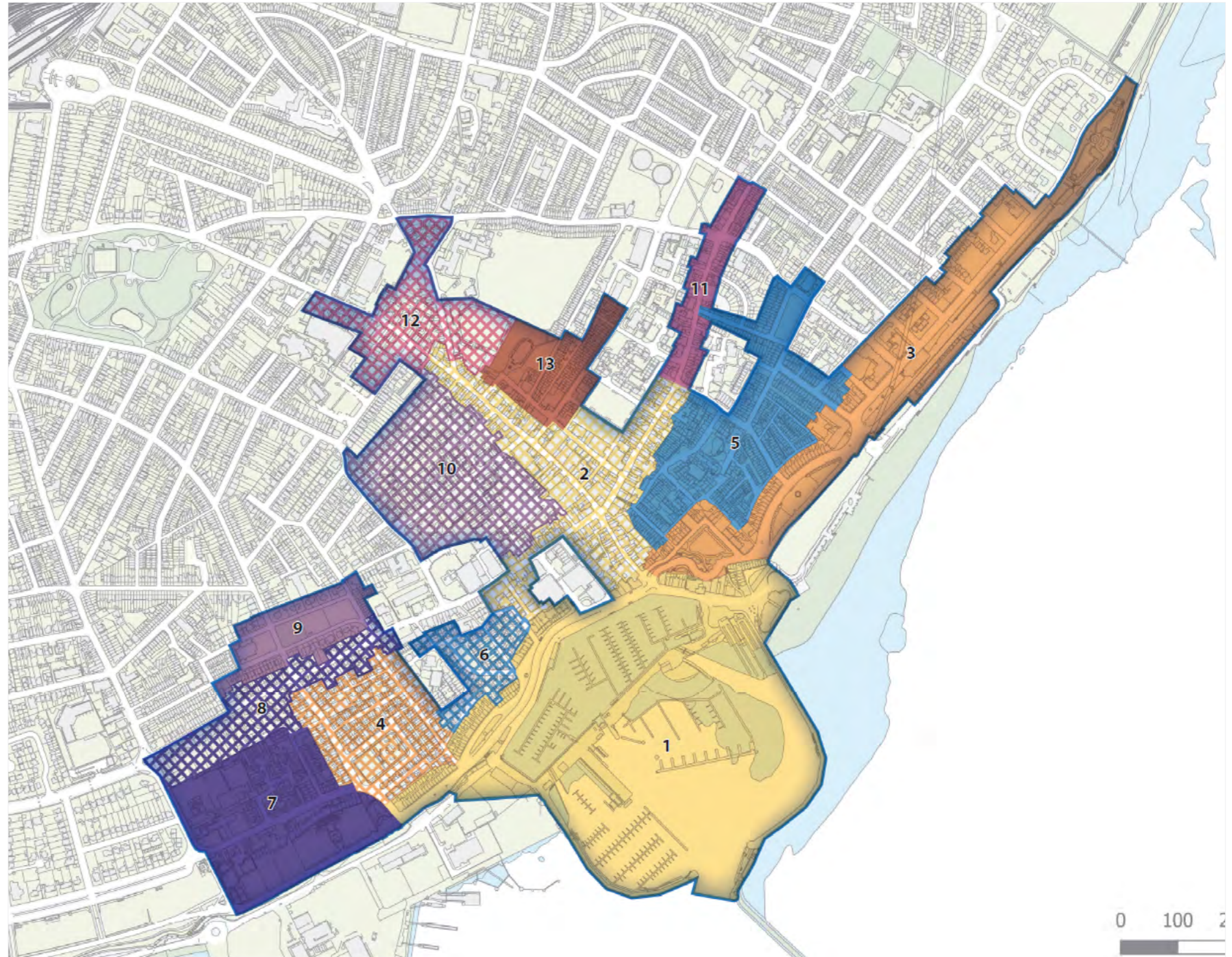

The Ramsgate Place Plan will:

- set out an urban strategy to **connect the LUF developments** to each other and the town centre
- propose methods to **unlock the potential** of Ramsgate's existing assets
- identify opportunities for **future investment**
- put forward measures to **improve access** into the core of Ramsgate
- **guide the delivery** of LUF projects to ensure that they meet the community's objectives

The conversation so far

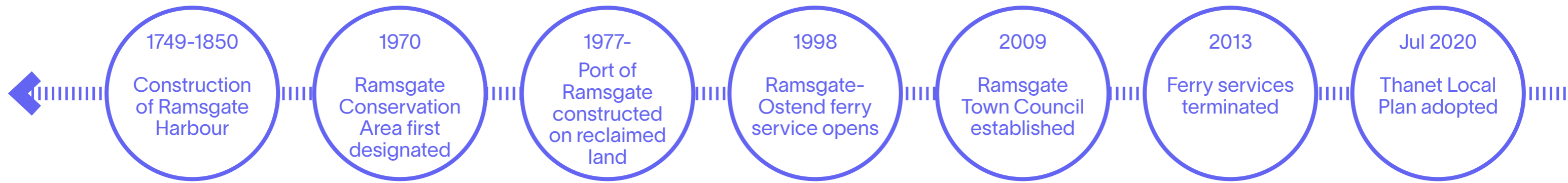

The conversation so far

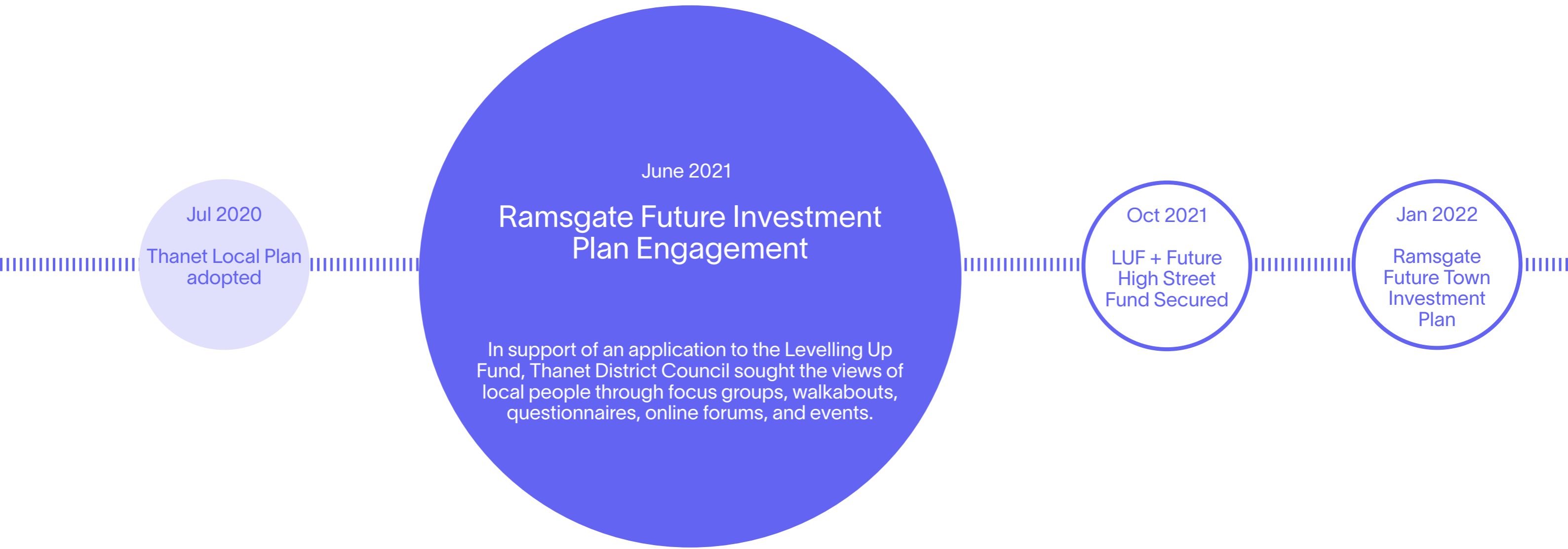

June 2021

Ramsgate Future Investment Plan Engagement

In support of an application to the Levelling Up Fund, Thanet District Council sought the views of local people through focus groups, walkabouts, questionnaires, online forums, and events.



- This engagement identified many of the people's perceptions, concerns, priorities, and vision for the town, which included:
- employment opportunities for young people
 - a desire to celebrate the town's historic identity
 - connectivity and public realm safety
 - support for local businesses

The conversation so far

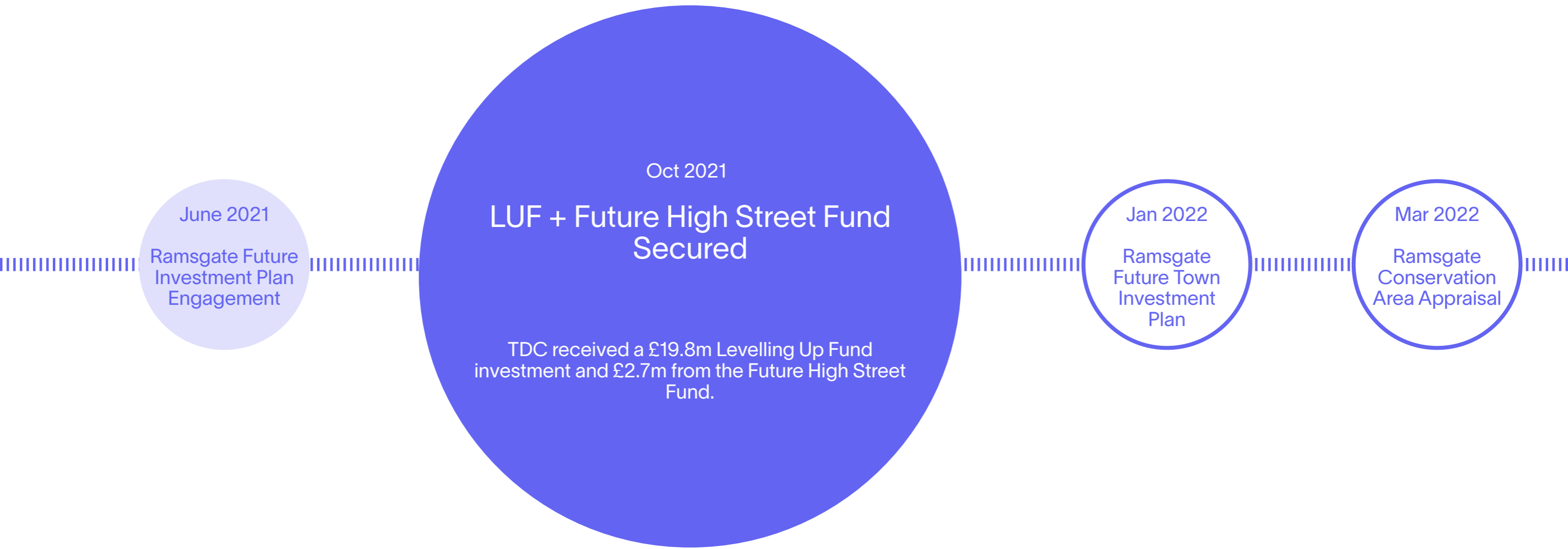

The insights from the Ramsgate Future Investment Plan Engagement paved the way for these investments in Ramsgate.

This funding opened up projects that seek to address the identified concerns and priorities of Ramsgate's community.

The conversation so far

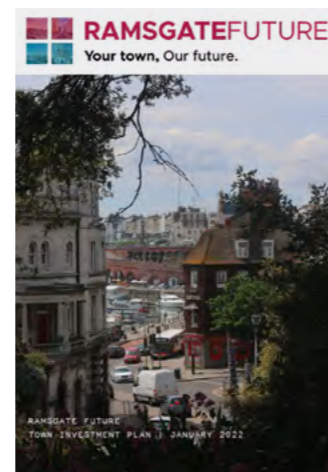
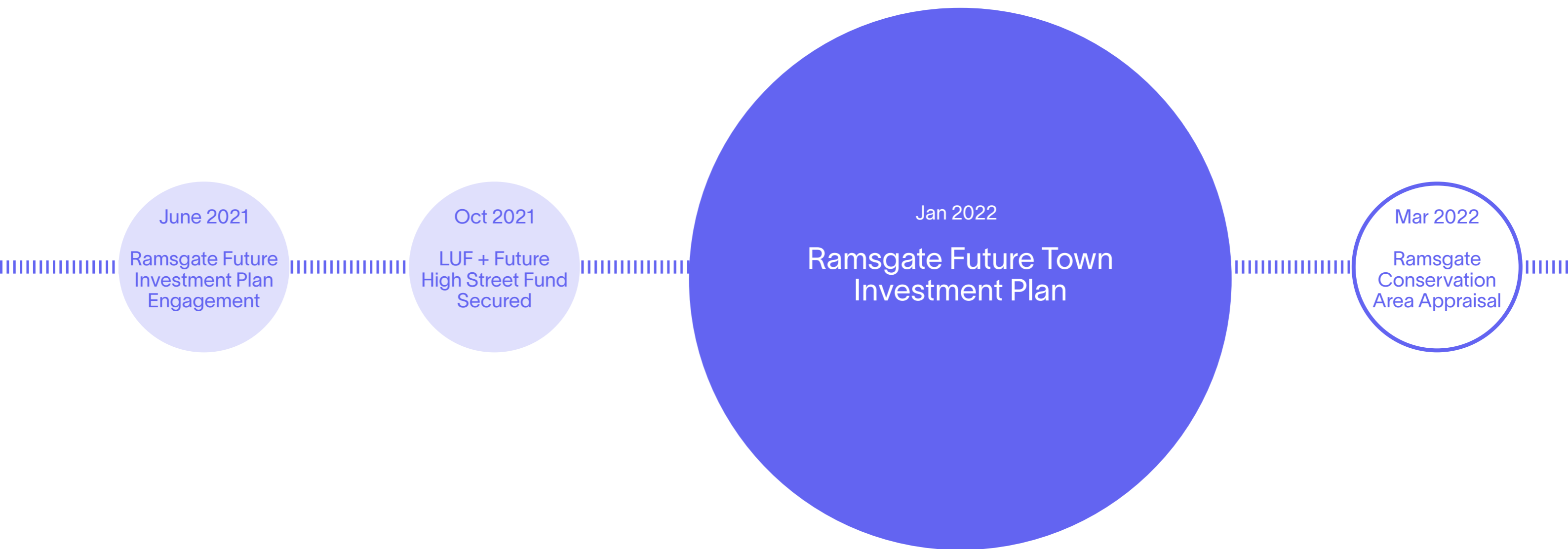

Building upon the identified opportunities and challenges from the initial engagement, the plan suggests:

- a distinguishing identity for Ramsgate tied to its heritage and maritime assets
- interventions, activities, and projects which guide the spending of the LUF and future investments

The conversation so far

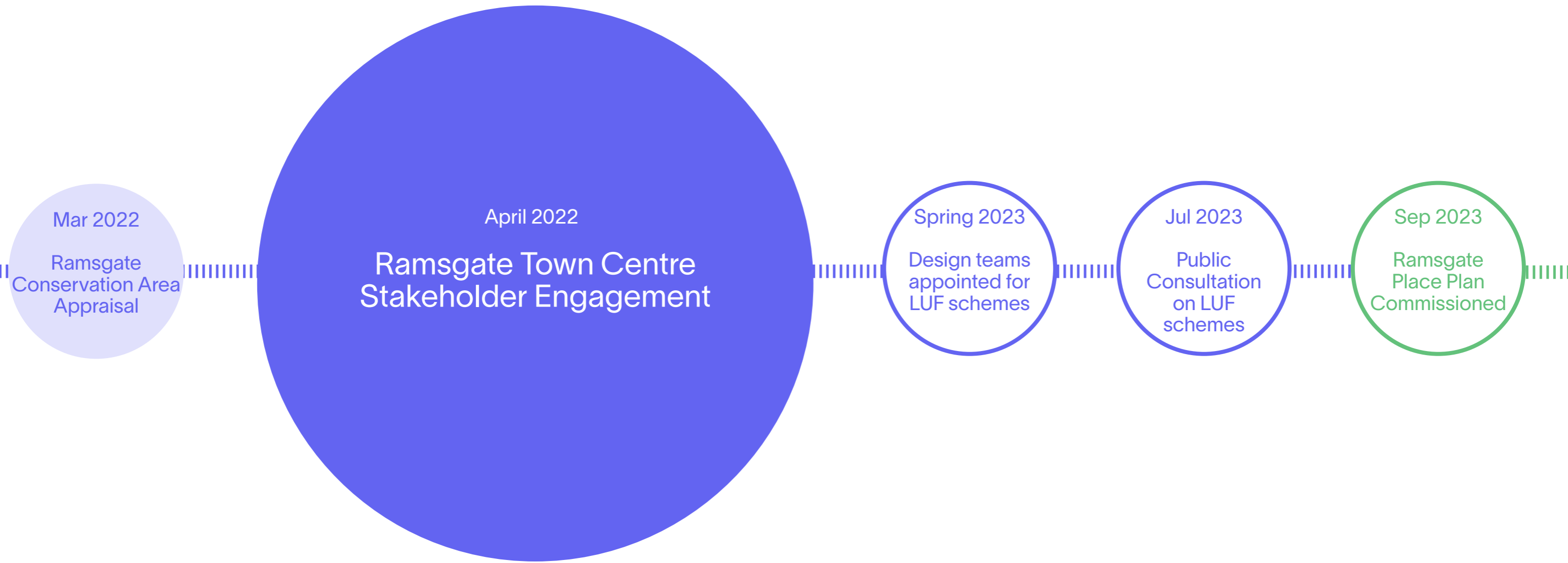

TDC, Historic England, Ramsgate Town Council & commercial letting agents were consulted about the challenges faced on the high street, and suggestions for improvement.

The result was this study which made recommendations to support the delivery of the High Street Heritage Action Zone (HSHAZ) project.

The conversation so far

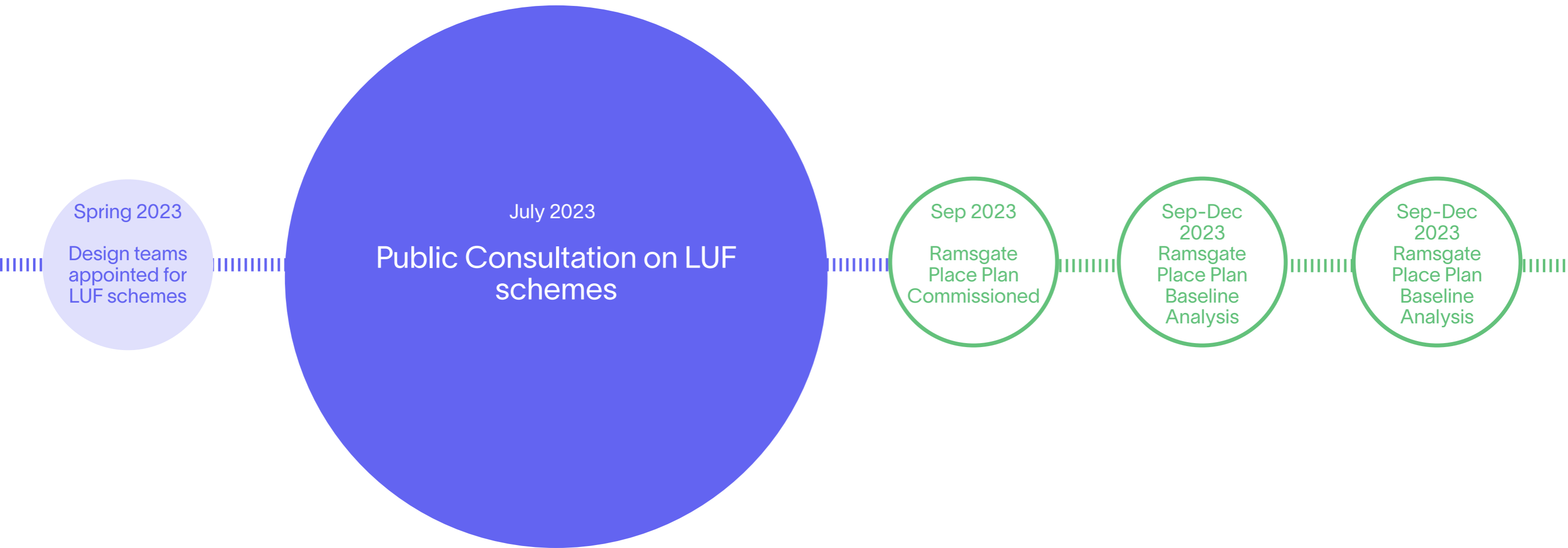

Stage 1 designs for all of the LUF projects were exhibited to the general public in the Royal Harbour. Over three hundred people attended to share their opinions. While most people continued to support the principles and aspirations of the LUF schemes, many had questions about how the schemes will be operated and how they will connect to the townscape around them.



Next steps

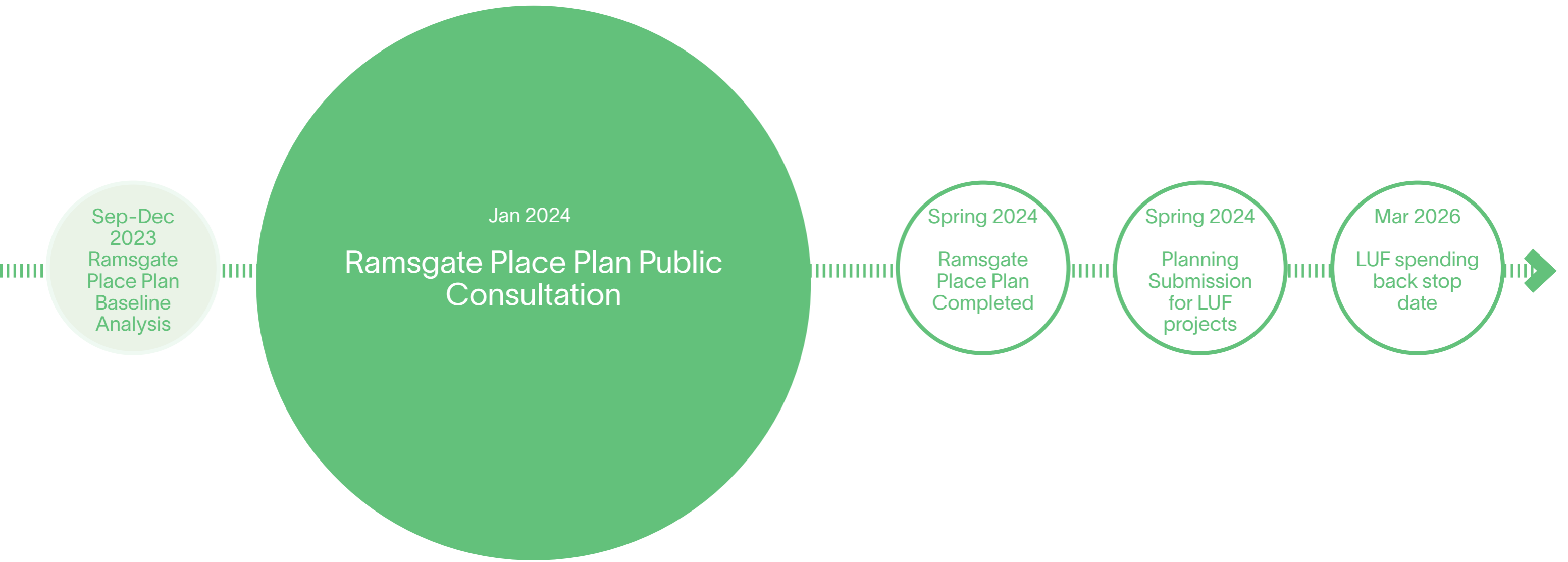

We are here!

The voices of the Ramsgate community have been central to securing generational investment in the town. Now, we are asking you to help ensure that this funding has the greatest possible impact.

We would like to discuss:

- how the LUF projects can best be integrated into the physical and social context of Ramsgate
- how current investment can maximise the benefits to residents, community groups and businesses
- which priorities still need to be addressed

The Ramsgate Place Plan will:

- set out an urban strategy to **connect the LUF developments** to each other and the town centre
- propose methods to **unlock the potential** of Ramsgate's existing assets
- identify opportunities for **future investment**
- put forward measures to **improve access** into the core of Ramsgate
- **guide the delivery** of LUF projects to ensure that they meet the community's objectives

Baseline analysis



Land Use

- Commercial/Retail
- Community + Faith
- Educational
- Residential
- Workspace/Industrial
- Transport Hub
- Sports + Recreation
- Cultural/Tourism



Opportunity Sites

- Council Owned Land
- 1 3 Railway Approach
- 2 High St (North)
- 4 Argos Site
- 5 Granville Theatre
- 6 Marina Esplanade
- 7 Queens House
- 8 Ramsgate Library
- 9 High St (South)
- 10 Ramsgate Tunnels
- 11 Main Sands Roundabout
- 12 Pier Yard + Clock House
- 13 Crosswall
- 14 Westcliff Hall
- 15 Audacious Marine
- 16 Westcliff Promenade
- 17 Smack Boys + Sailors Church
- 18 Green Campus
- 19 Western Undercliff Beach
- 20 Boating Lake
- 21 Royal Harbour Tunnel
- 22 Port Facilities
- 23 Addington Street
- 24 Royal Mail Site
- 25 Warre Recreation Ground
- 26 Melbourne Avenue Housing Site
- 27 79-85 High Street Housing Site
- 28 Albert Court
- 29 Ramsgate Bandstand
- 30 Military Road
- 31 9 Townley Street Housing Site
- 32 Complete Car Sales Housing Site
- 33 Gas Works Housing Site
- 34 35 36 37 38 Surface Parking

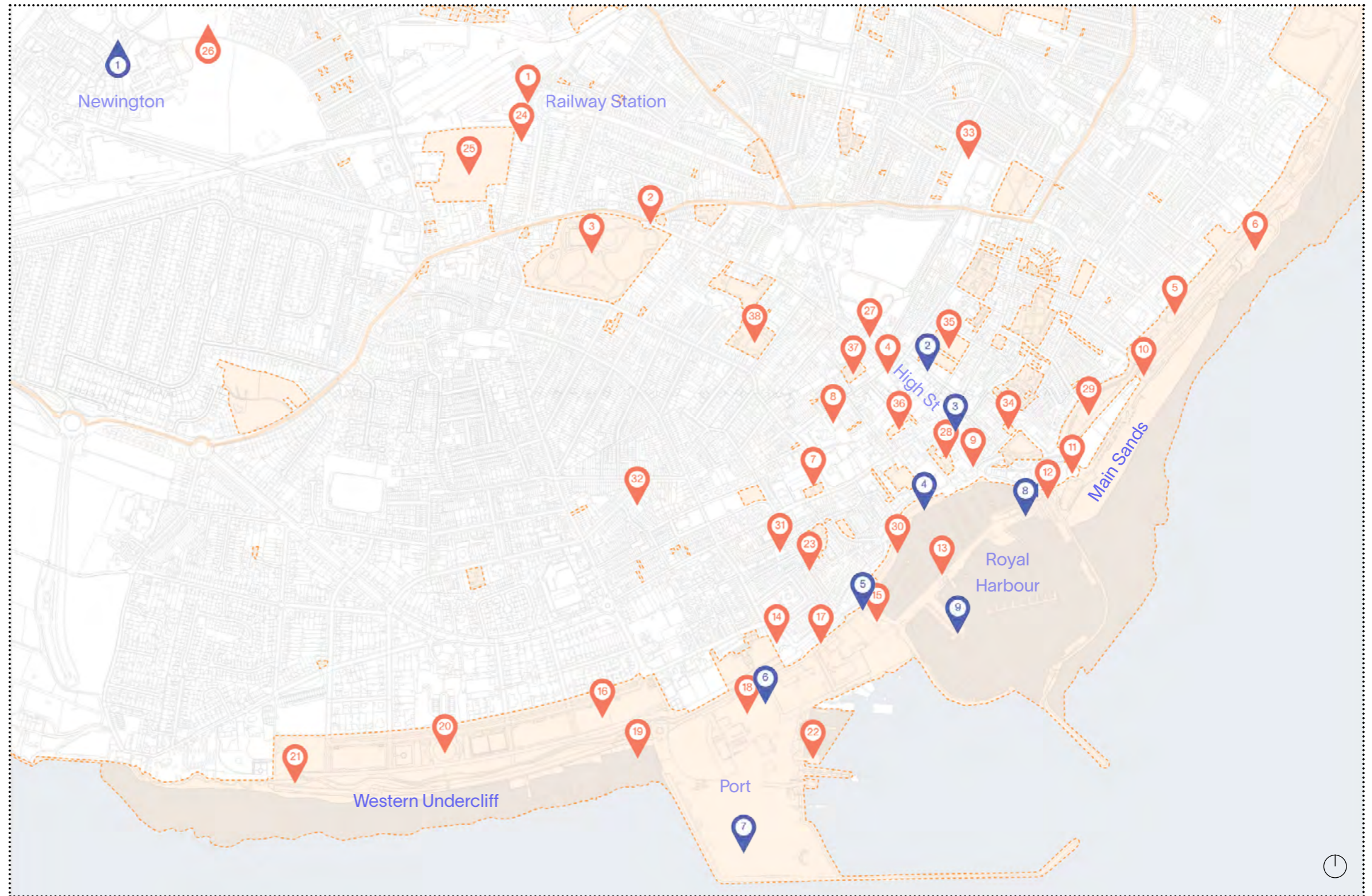

Character Areas + Key Axes

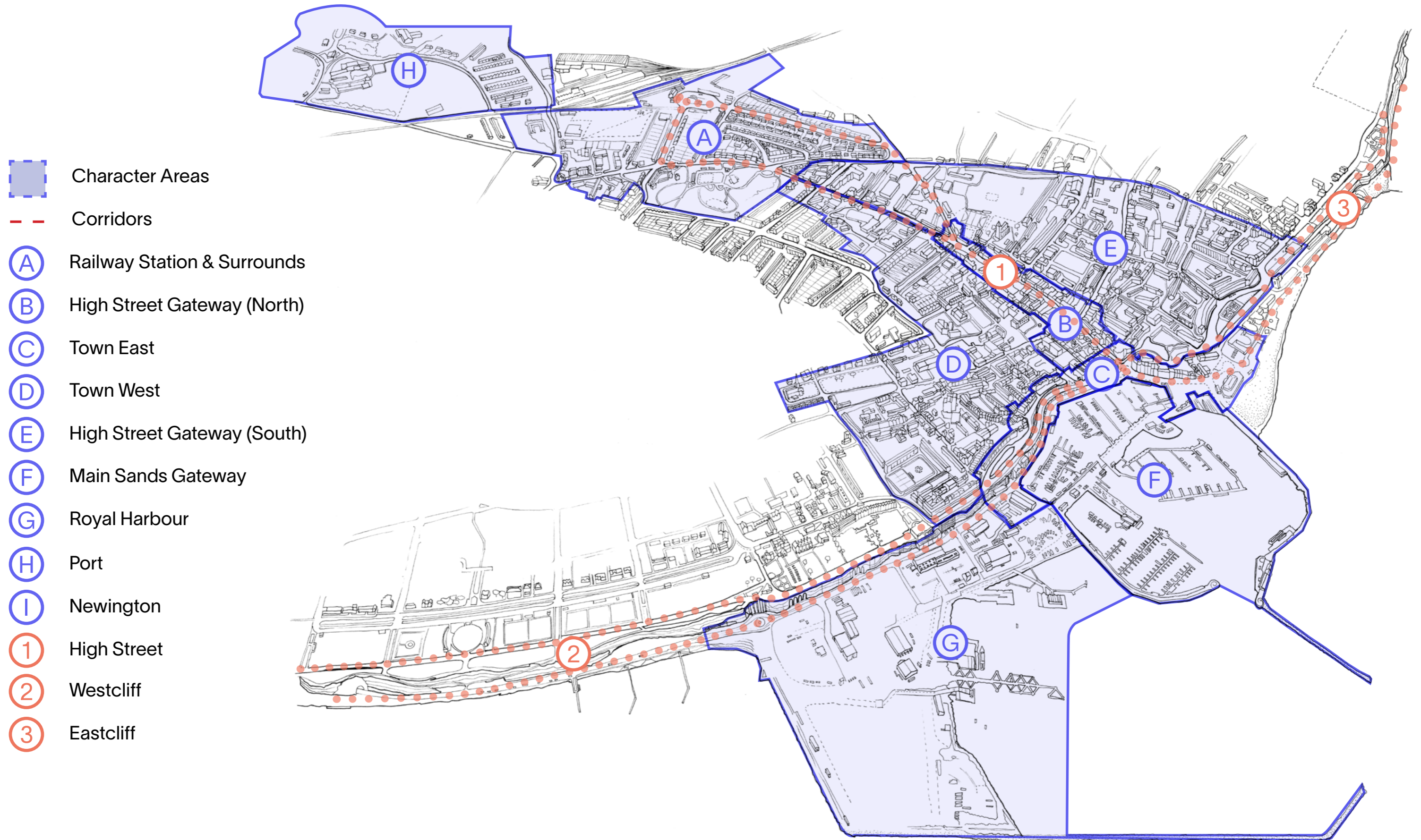

Sites of Focus

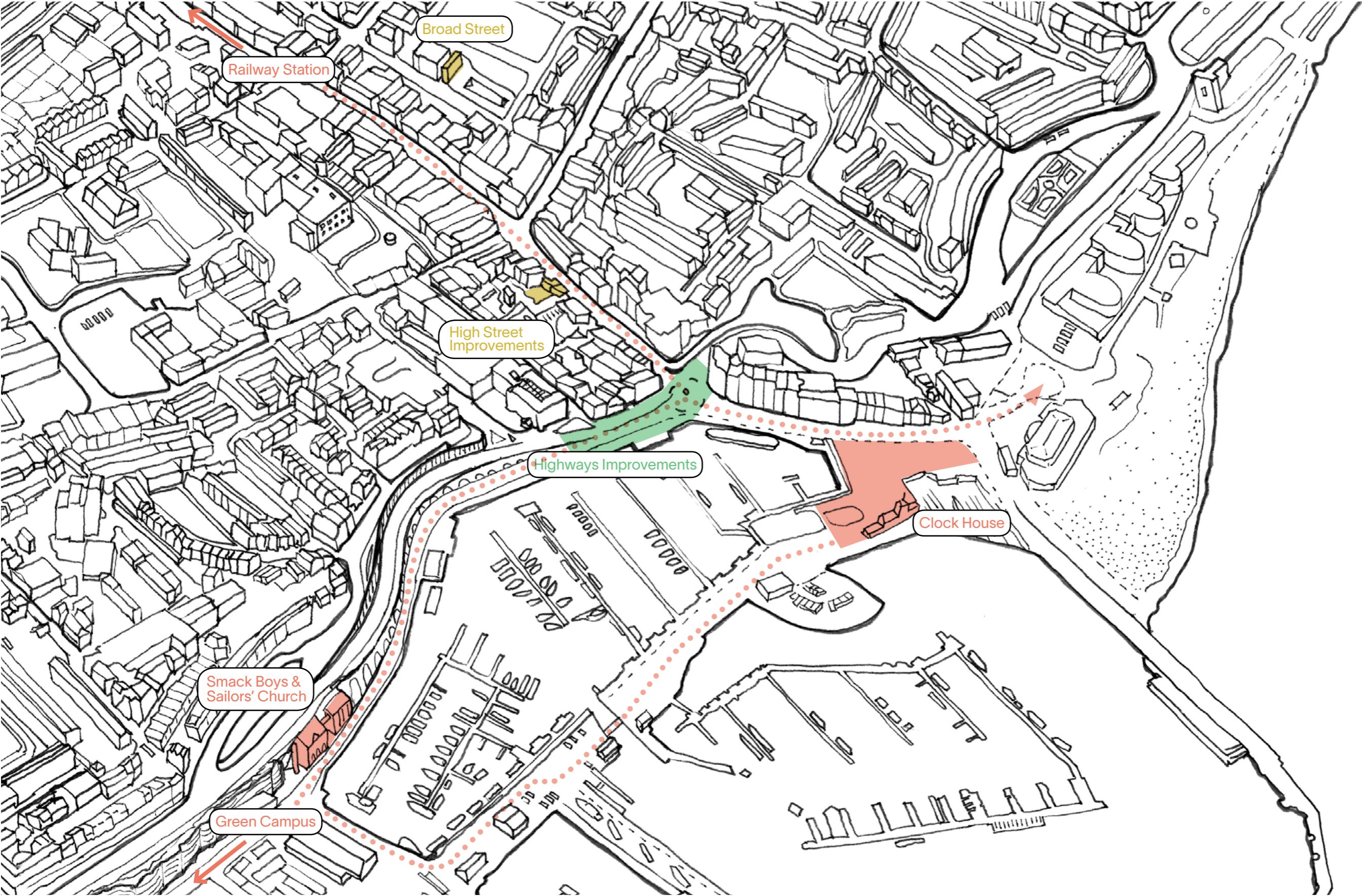

Sites of Focus

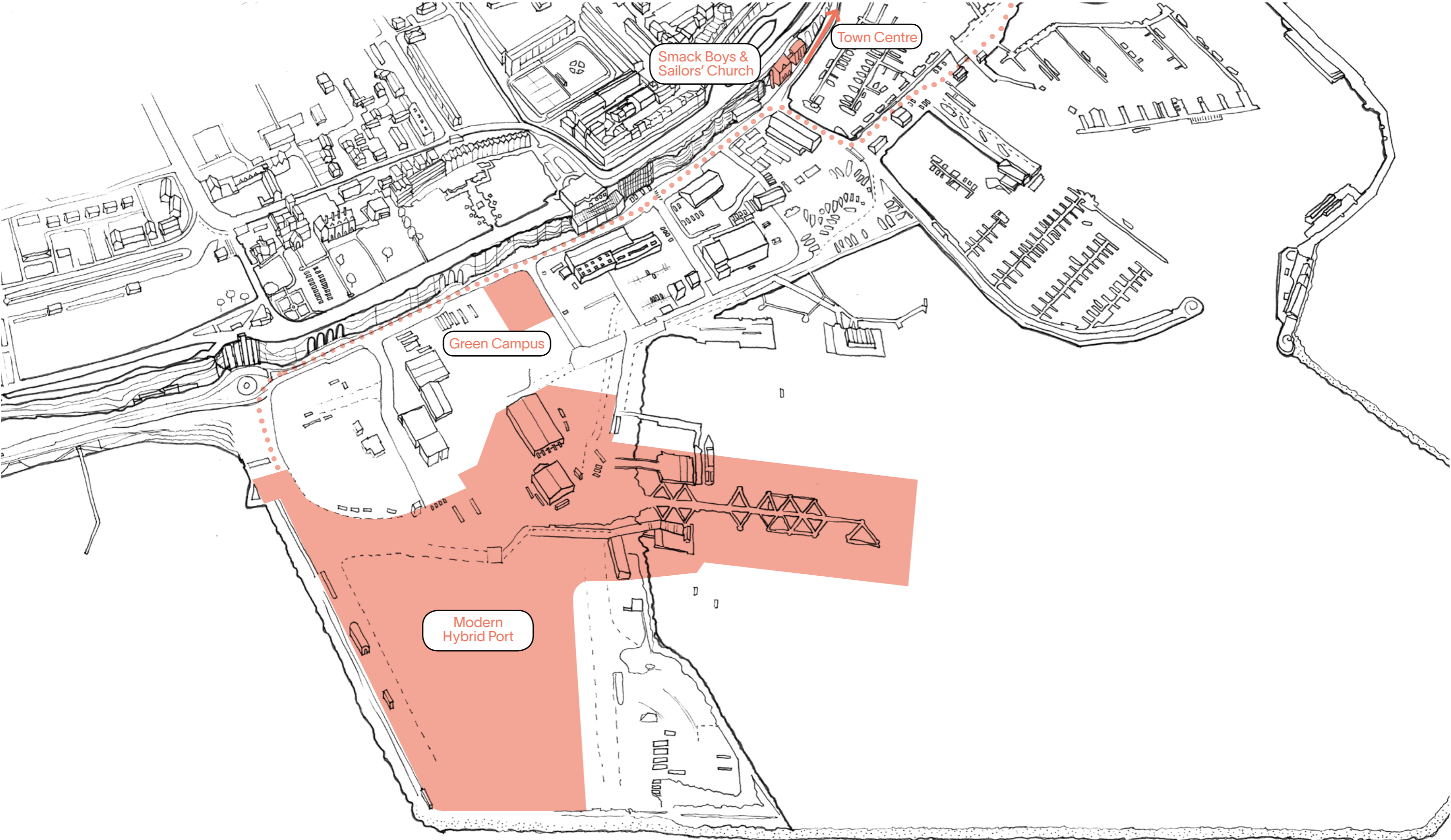

Sites of Focus

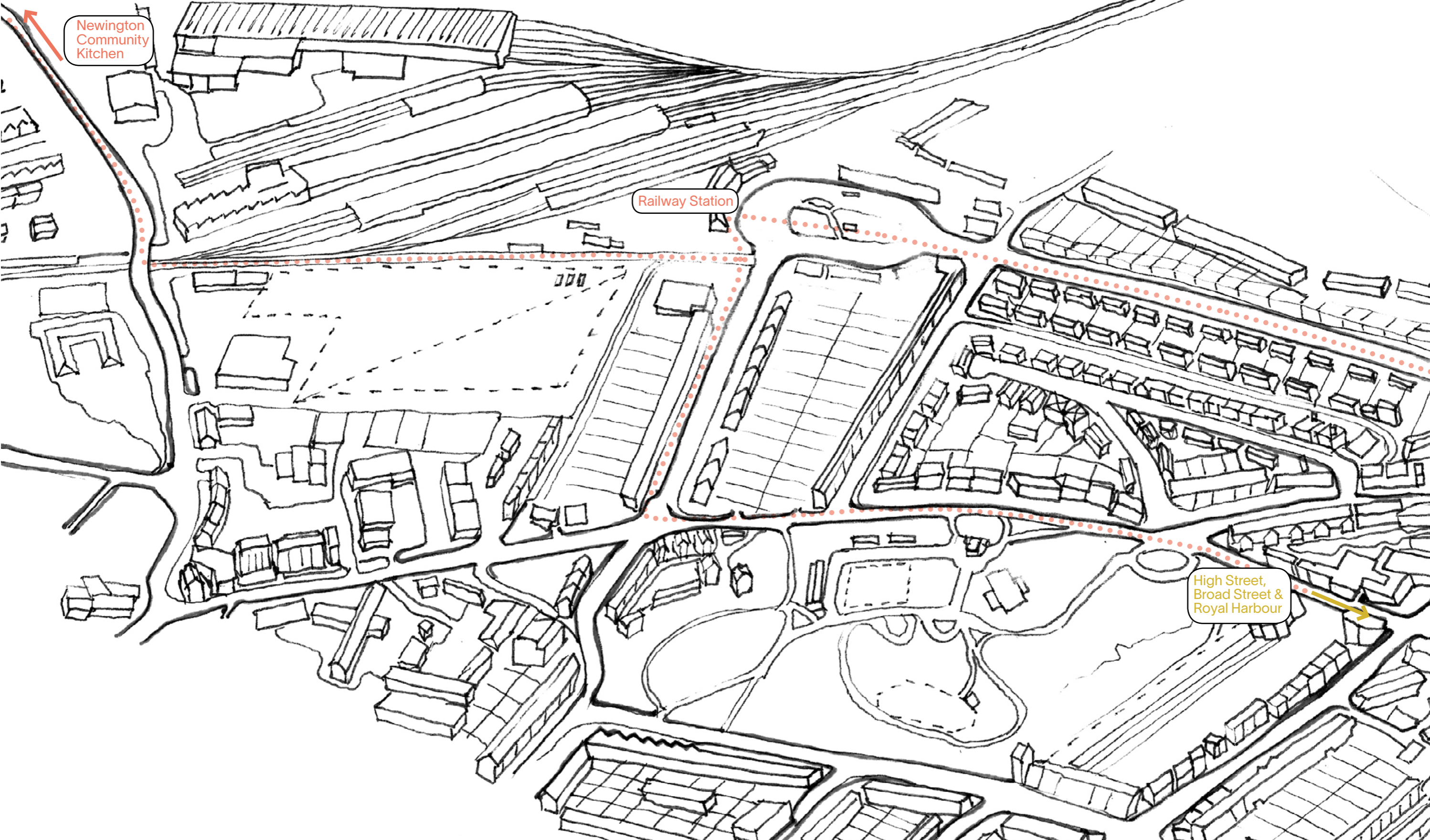

How can Ramsgate
work better?



Key Considerations for the Place Plan

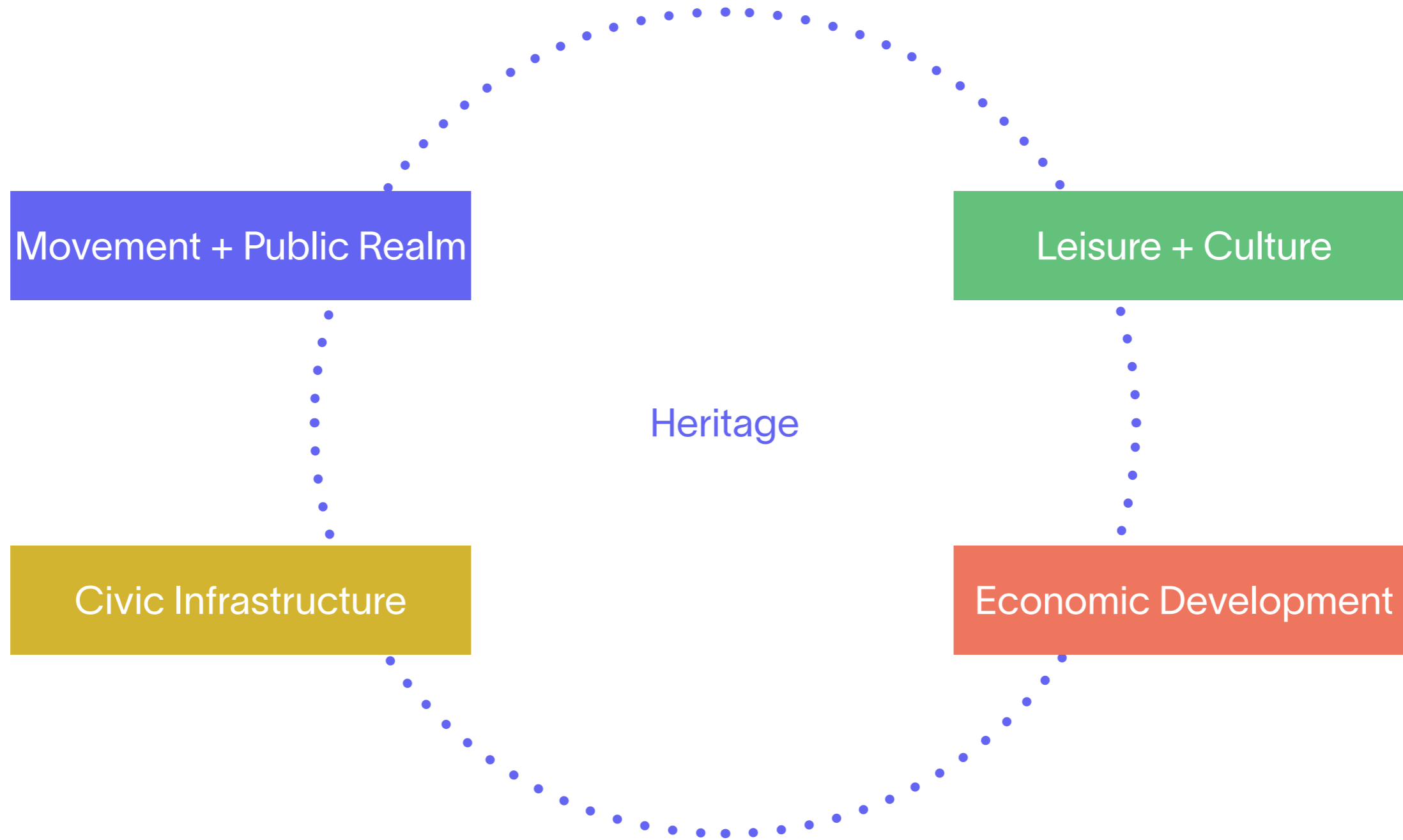

Why is it important?

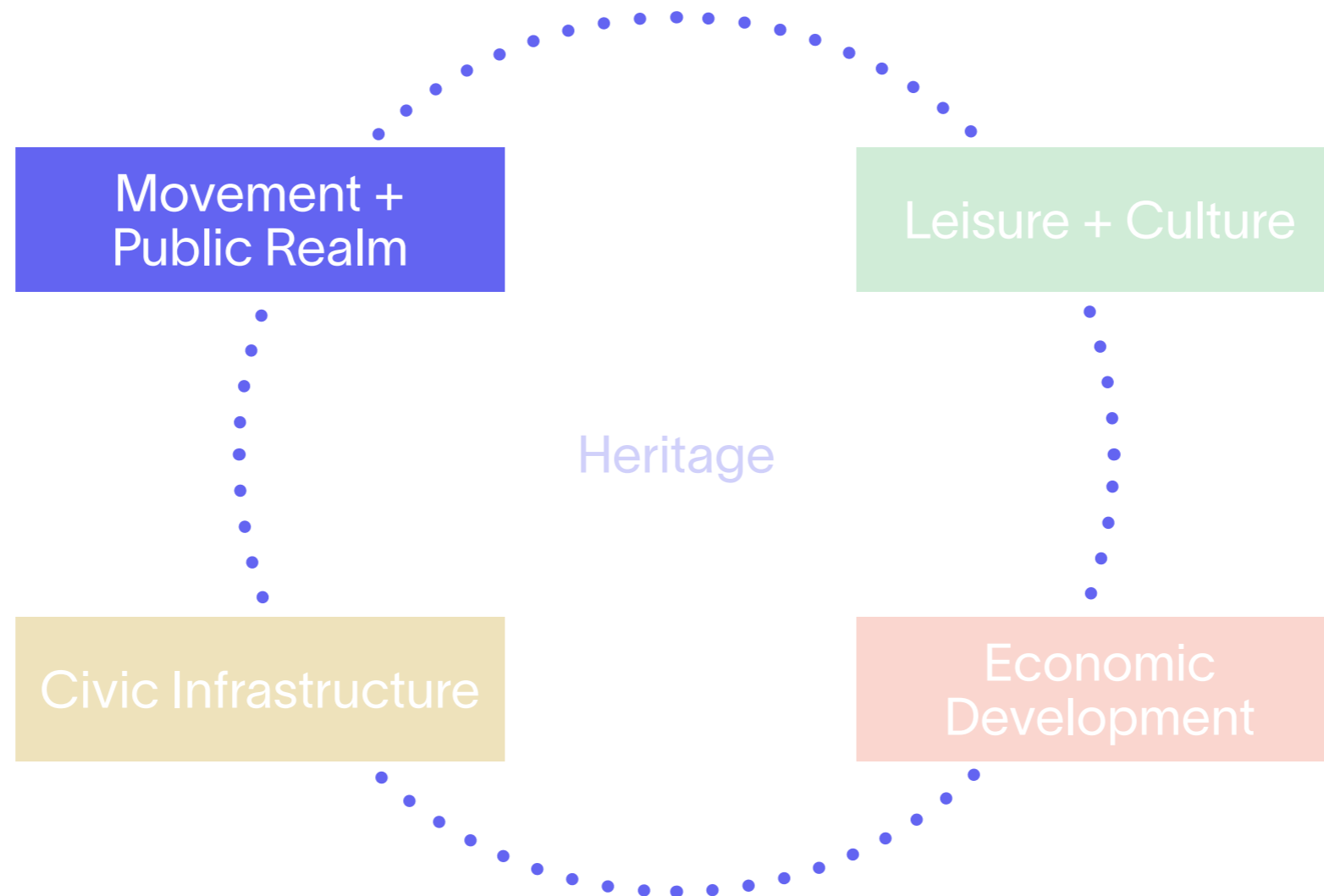

- Getting the balance right between vehicle traffic and pedestrian environment will be critical to balancing a working harbour, resurgent Port with a Town Centre that people want to live in and visit.

Why is it important?

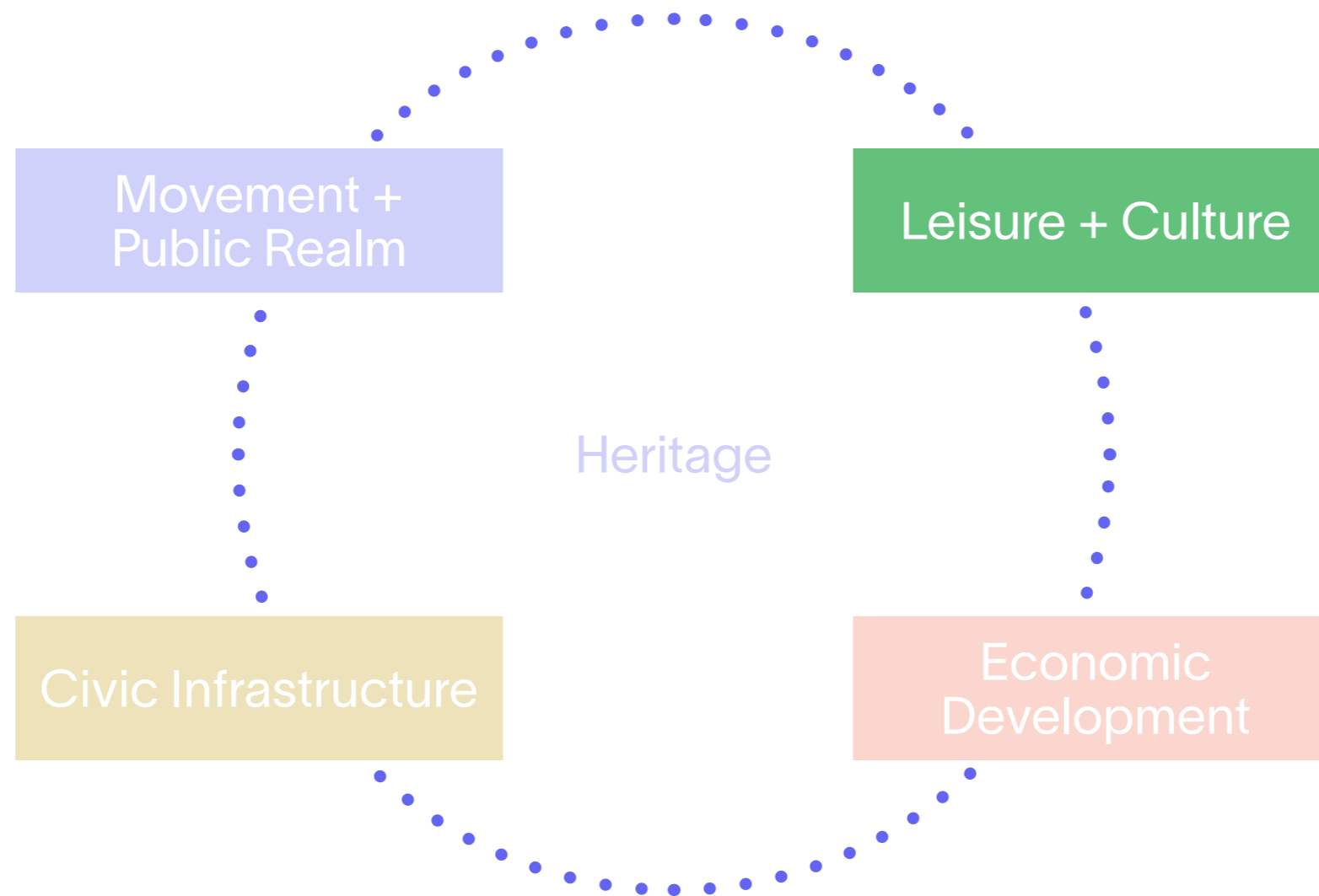

- LUF investment will help to make the more of Ramsgate's landscape setting and historic fabric. How new spaces are animated and integrated with the existing scene will be essential to benefitting existing residents while also attracting visitors.

Why is it important?

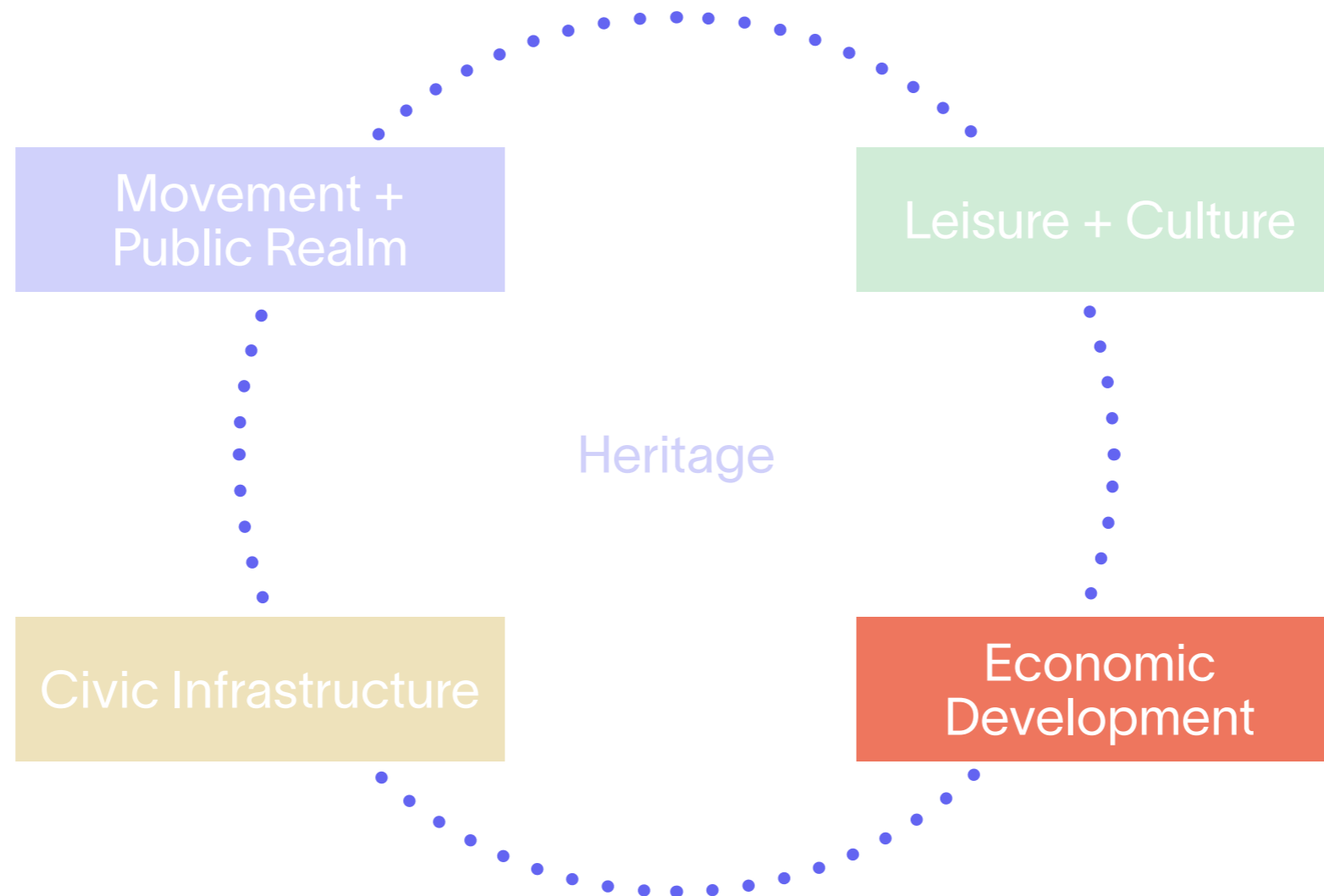

➤ The lack of job growth in Ramsgate is a key driver for LUF investment. How can we ensure that economic growth is sustainable and benefits everyone?

Why is it important?

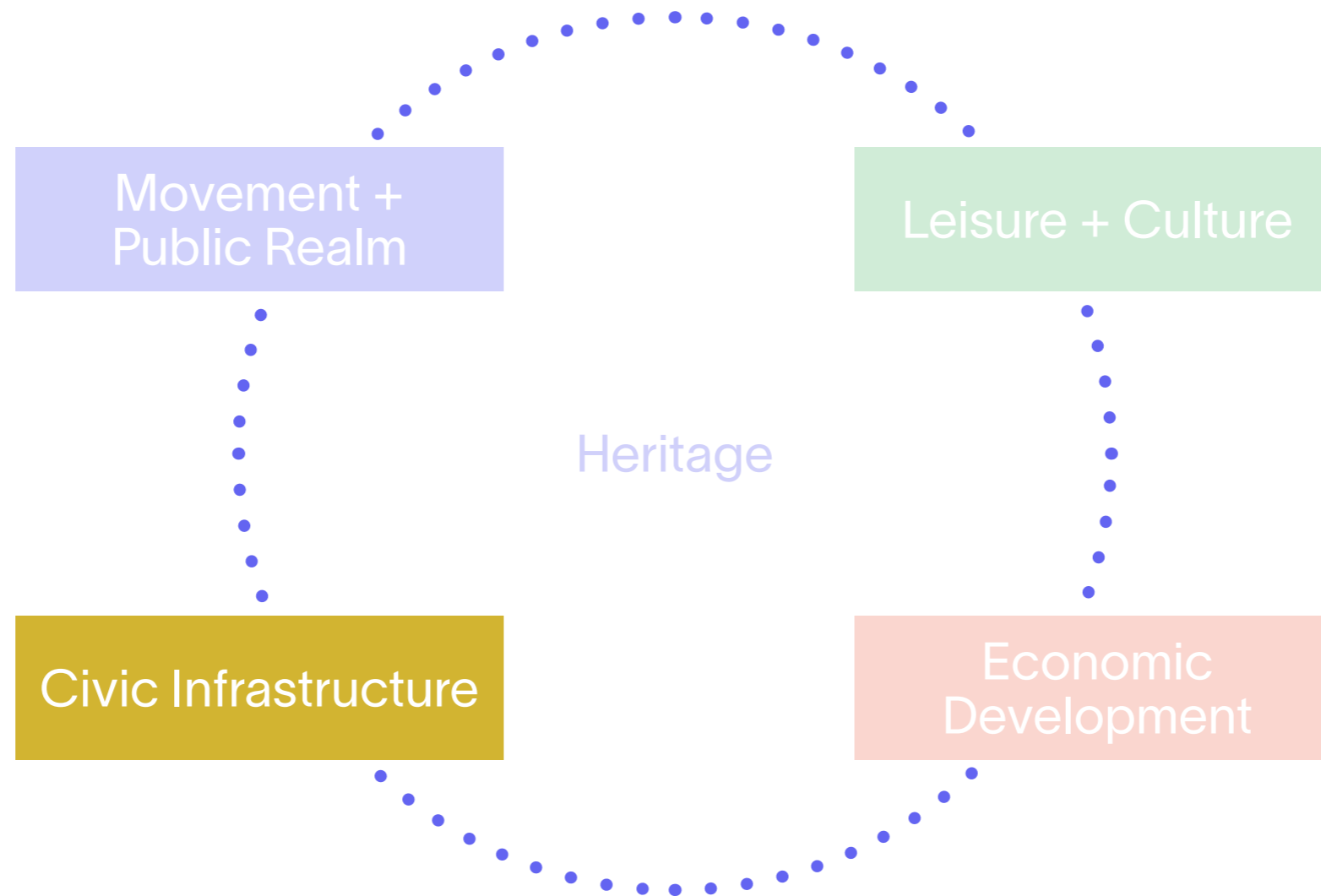

- Ramsgate's community spaces, networks and assets are already critical to well-being. How might improvements support residents to take advantage of opportunities brought about by LUF investment?

What ties them together?

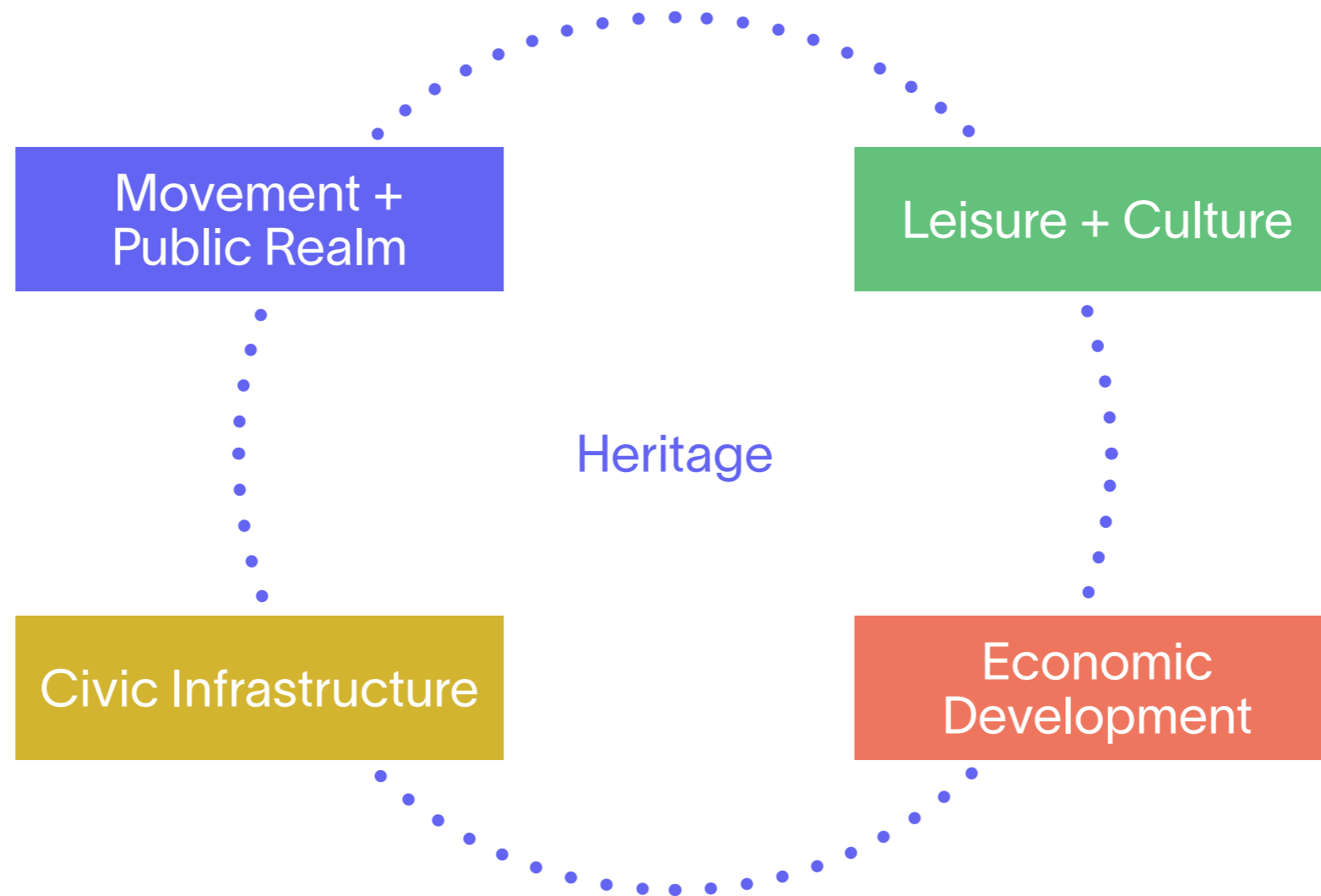

Previous stakeholder engagement highlighted the central importance of Ramsgate's heritage to the town's identity. The Place Plan will consider how heritage assets can contribute across focus areas.



Movement + Public Realm

CANNON S →
FOR LOCAL FISH →
FRESH →
SKATE →
COD RIG →
SOULD HUSS →
COD SOLE →
HADDOCK →
TUNA DABS →
PLAICE →
SALMON →
BASS BREAM →
MONKFISH →
CLOCK TOWER THURS →
MAR PARK FRI →
SAT

Movement + Public Realm



↳ Precedent: Torquay Inner Harbour

Leisure + Culture





▾ Precedent: Wallasey Beach Club

Leisure + Culture

↳ Precedent: Dartmouth Royal Regatta



Civic Infrastructure





↳ Precedent: Claridge Way exercise benches, Thamesmead



▾ Precedent: Fore Street Living Room Library

Economic Activation



Economic Activation



↳ Precedent: Wealdstone youth programme

Economic Activation



The voices of the Ramsgate community have been central to securing generational investment in the town. Now, we are asking you to help ensure that this funding has the greatest possible impact.

We would like to discuss:

- how the LUF projects can best be integrated into the physical and social context of Ramsgate
- how current investment can maximise the benefits to residents, community groups and businesses
- which priorities still need to be addressed

Key Considerations for the Place Plan

